



FUSE SELECTION GUIDE

IMPORTANT

For best protection, select fuse that best fits the heated gear(s) in use. Using a fuse rated higher than required will not provide proper protection and can result in equipment failure, fire, or damage to your heated gear, and your motorcycle. Using a fuse lower than needed can cause a blown fuse; the battery harness will not work as intended.



HEATED GEAR POWER DRAW

Heated Vest	GT-28 / MC-10/ MC-15 / MC-18	3.5 AMPS
Heated Jacket	GT-40 / MC-38	7 AMPS
Heated Pants Liner	GT-30 / MC-20	3.5 AMPS
Heated Gloves	MC-225 / MC-235 / MC-245	2.2 AMPS (per pair)
Heated Gloves	MC-125 / MC60	1.3 AMPS (per pair)
Heated Insole	MC-50	2 AMPS (per pair)



USE THE LOWEST RATED FUSE THAT IS ABOVE TOTAL CURRENT DRAW

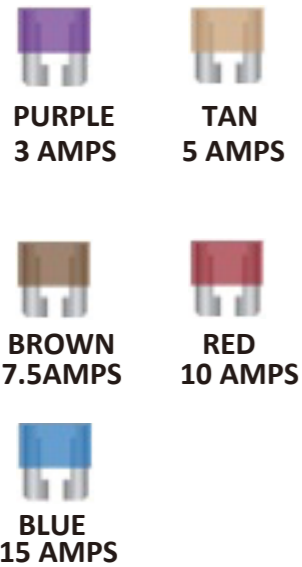

*** Insert the FUSE all the way into the housing.**

*** Close the Protective Cover.**

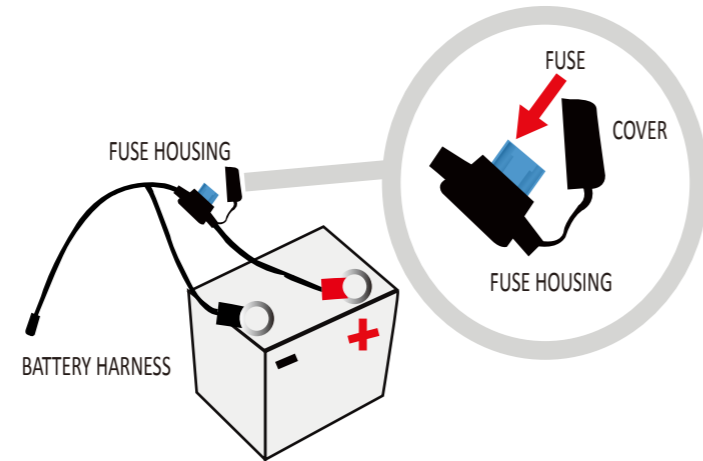

Visit our website for more info: www.VentureHeat.com



Fuse Selection Examples

COMBO A. Heated Jacket (7A) + Pants (3.5A) + Gloves (2.2A) + Insole (2A) = 14.7 Amps

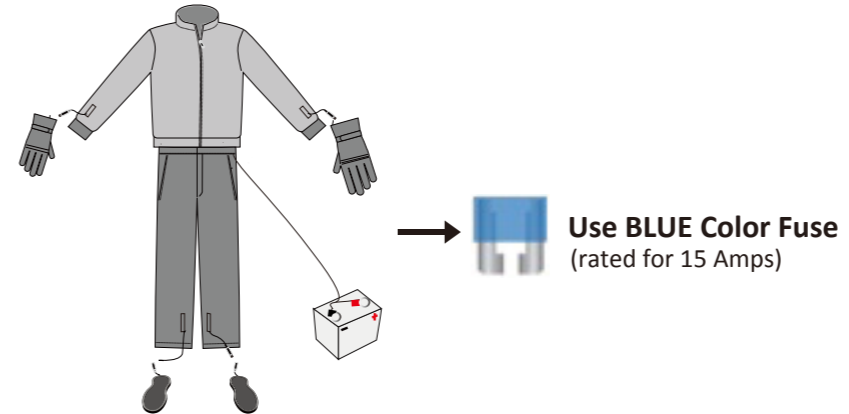

COMBO B. Heated Jacket (7A) + Gloves (2.2A) = 9.2 Amps

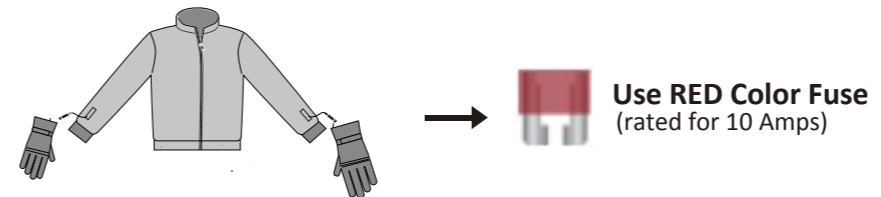

COMBO C. Heated Jacket (7A.) Only = 7 Amps



IMPORTANT

- * If you plan on sharing one Battery Harness between Rider & Passenger, be sure that the total draw does not exceed 15 AMPS!
- * Consider using a second Battery Harness if you noticed the cable is HOT.
- * If the Battery Harness stopped providing power to the heated gear, check the fuse condition. (Replacement may be purchased at AUTO PARTS store.)